

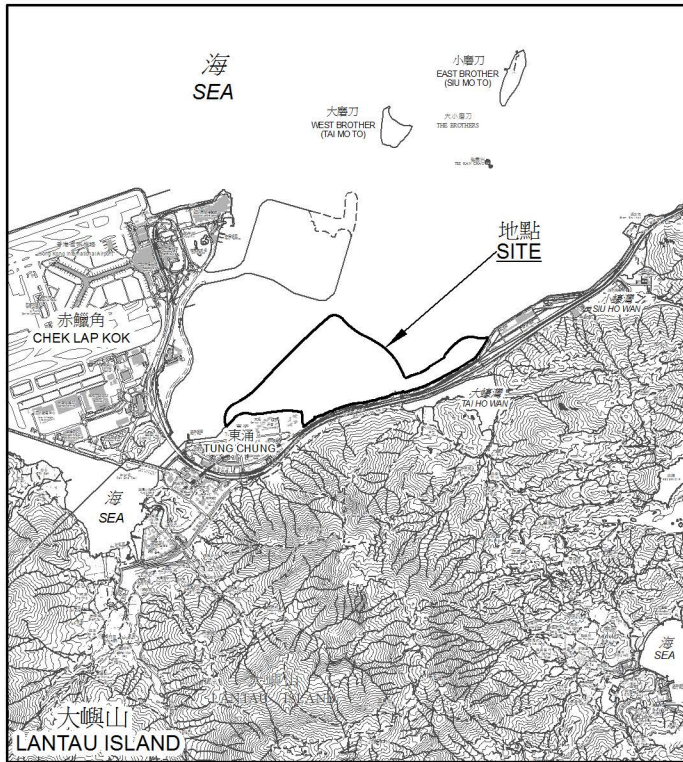

位置 LOCATION



比例 SCALE 1:100 000

圖例 LEGEND

-  受影響的前濱及海床範圍  
FORESHORE AND SEA-BED AFFECTED
-  將進行填海工程的前濱及海床  
以闢拓約129公頃土地  
FORESHORE AND SEA-BED TO BE RECLAIMED  
TO FORM ABOUT 129 HECTARES OF LAND

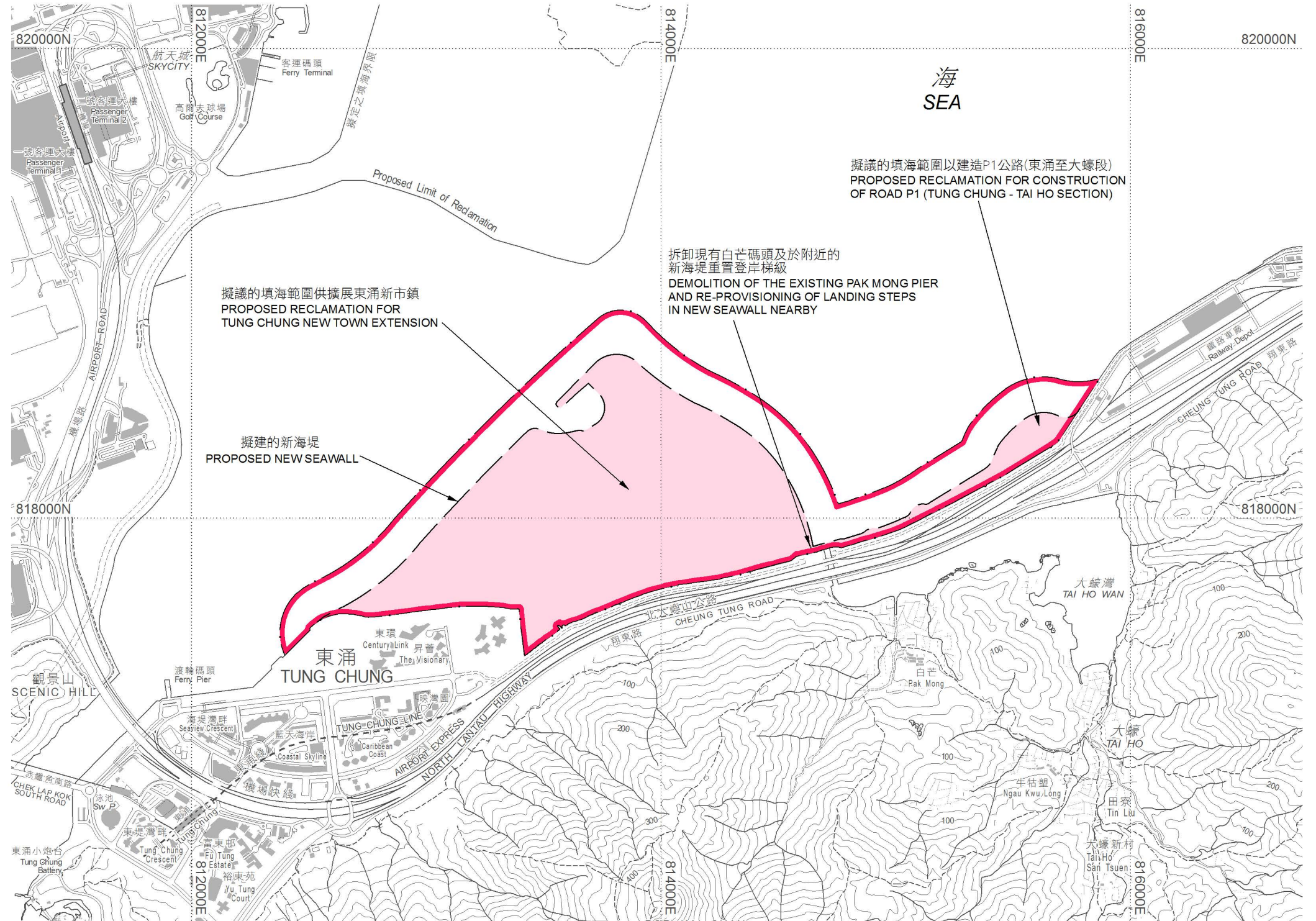

以紅色邊線標示的面積約為 200 公頃 EDGED RED AREA 200 HECTARES (ABOUT)

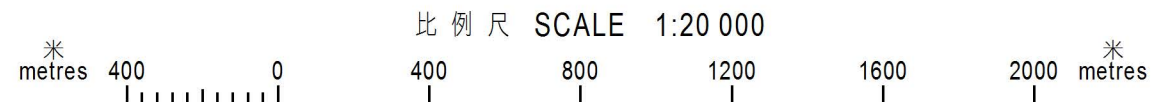

SIGNED  
 ( Olga LAM )  
 副署長(專業事務) Deputy Director / Specialist  
 地政總署 30 / 12 / 2015  
 Lands Department  
 圖則由離島測量處繪製  
 Plan Prepared by District Survey Office, Islands  
 © 香港特別行政區政府 版權所有 Copyright reserved - Hong Kong SAR Government

前濱及海床(填海工程)條例(第127章)  
 工務計劃項目第7786CL號  
 東涌新市鎮擴展  
 FORESHORE AND SEA-BED (RECLAMATIONS) ORDINANCE (CHAPTER 127)  
 PUBLIC WORKS PROGRAMME ITEM No. 7786CL  
 TUNG CHUNG NEW TOWN EXTENSION

檔案編號 File No. LD DLO/IS 05/CRN/2015/A/NLT  
 測量圖編號 Map Sheet No. 9 & 10 (組別 Series HM20C/2)  
 發展藍圖編號 Layout Plan No. -----  
 參考圖編號 Reference Plan No. 219844/GZ/005A (CEDD)  
 圖則編號 PLAN No. ISM2583b